

female

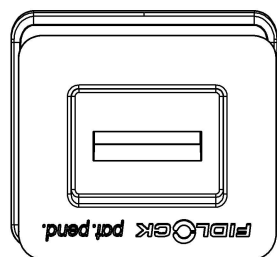

male



female

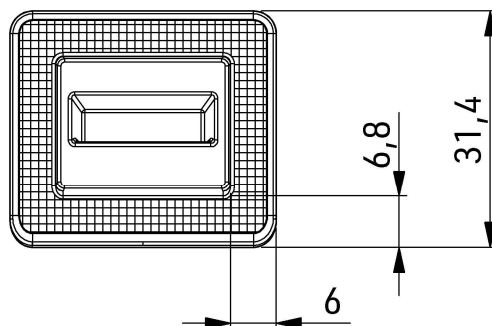

male

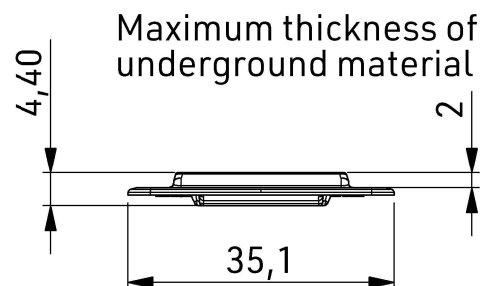
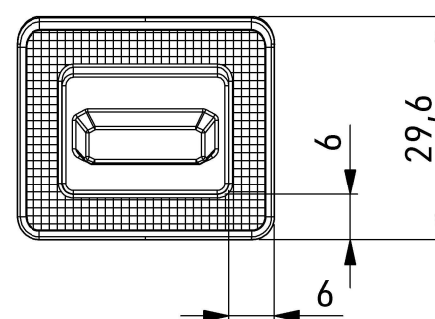

Maximum thickness of underground material

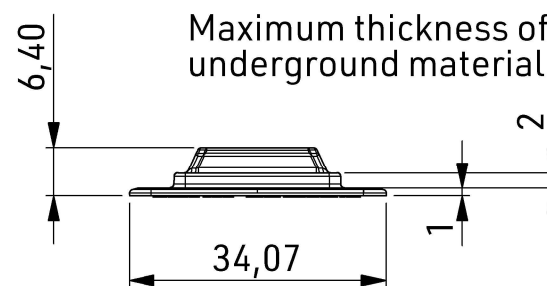

Maximum thickness of underground material

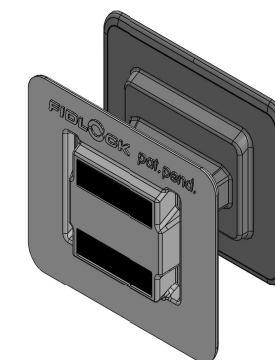

<b>PRODUCT</b>	Stripe X1 underlay
<b>APPLICATION</b>	sewable
<b>OPENING</b>	lift
<b>MATERIAL</b>	PA6
<b>COLOUR</b>	
<b>COLORABLE</b>	only black
<b>WEIGHT</b>	7,5 g
<b>LOAD CAPACITY</b>	-
<b>GENERAL NOTES</b>	X1 = one step on male part (not adjustable); Underlay = punch hole first, insert part from backside, stitch from fronside)

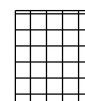

Stitching area

Proceed like stitching zipper  
Use a zipper presser foot and stitch length 2-3 mm  
(For securing the thread we recommend choosing a position next to the Fidlock part. Otherwise stability could be reduced.)

<b>ARTICLE NO.</b>	01362-000001 (BLK)
<b>SCALE</b>	1:1
<b>DATE</b>	14.04.2021
<b>AUTHOR</b>	SO

patented technology.